



**“COMFORTS OF HOME” IS MORE THAN OUR NAME, IT’S OUR PROMISE.**

### **Comforts of Home Creates the Finest in Assisted Living**

If you could create the ideal senior living arrangement for your parents (or yourself), it’s likely you’d go through much the same process we did when planning our Comforts of Home assisted living apartments in Chippewa Falls, Wisconsin.

Building on our years of experience owning and operating senior housing and assisted living properties, we understood that folks want an affordable, safe environment that strikes the right balance between their needs and their independence.

### **The Concept**

So we found a beautiful tree filled setting along the Chippewa River with room for a two-story 21-unit apartment building and an outdoor patio and walking paths.

Our planning began with home-making in mind. Each suite has a modern, convenient kitchenette with stove/oven, refrigerator and microwave. You can prepare anything from a light breakfast to a full home-cooked meal. Each suite has its own laundry and private bath or shower designed for easy access. The suite has plenty of comfortable living areas and large windows for viewing the ever-changing Wisconsin seasons. There is an emergency call system for safety. Suite maintenance, weekly housekeeping, flat linen service and meals and snacks are also available.

Outside their suites, folks will find a full schedule of planned social, educational and cultural activities along with easy access to a beauty/ barber shop. There’s underground parking for those who drive, and scheduled transportation for those who don’t.

### **Living Here**

Comforts of Home assisted living is an affordable, preferable alternative to other senior living environments. This is living without the worries of aging. This is also living without the worries of real estate taxes, mortgage payments, insurance, utilities, snow shoveling, lawn mowing and maintenance.

We put together a senior living rental package that includes everything listed on the next page. We also developed a menu of available services that support continued independence.

We are building now to meet a demand expressed over the past several years by many families and seniors. Contact us today and we’ll take the worry out of senior care. You’ll be glad you did!

**Comforts of Home • 1224 Pumhouse Road, Chippewa Falls, WI 54729 • 715.529.4725 or 800.920.4725**

# Chippewa Falls, Wisconsin Assisted Living Apartments



## Assisted Living Private Apartment Rates:

Deluxe Studio	\$2,725
Deluxe One Bedroom	\$3,025
Second Person	\$1,200

## Amenities Include:

- 24-Hour Personal Care Staff Available
- Health and Wellness Program
- Medication Supervision
- Suite Maintenance and Weekly Housekeeping
- Flat Linen Service
- Scheduled Transportation
- Planned Social, Educational, and Cultural Activities
- Hair Care Salon
- River-Front Location
- Spacious Suite with Kitchenette, including Stove/Oven, Refrigerator and Microwave
- Emergency Call System
- Heat, Electricity, Water and Air Conditioning
- Complimentary Cable TV Services
- Breakfast, Lunch and Dinner Service Including Snacks Available
- Complimentary Laundry Facilities
- Use of all Common Areas Including Library, Outdoor Patio, Activities Area

## Other Services Available:

Personal Laundry	\$60.00 per month
Resident Meals	\$5.00 per meal average
Guest Meals	\$8.00 each
Beauty and Barber Services	(prices available)
Heated Underground Parking & Storage	\$85.00 per month
Rehabilitation therapies including Physical Therapy and Massage	

## Personal Care:

Up to 1 hour per day	\$550.00 per month
Up to 2 hours per day	\$1,100.00 per month
Up to 3 hours per day	\$1,650.00 per month
Medication Administration	\$550.00 per month

*For the person who is independent and requires only occasional supportive assistance, please ask about our Independent Rate.*

**Comforts of Home • 1224 Pumhouse Road, Chippewa Falls, WI 54729 • 715.529.4725 or 800.920.4725**

[WWW.COSENIORLIVING.COM](http://WWW.COSENIORLIVING.COM)

©2012 Comforts of Home Holdings, LLC



**Comforts  
OF Home**<sup>®</sup>  
*Assisted Living*

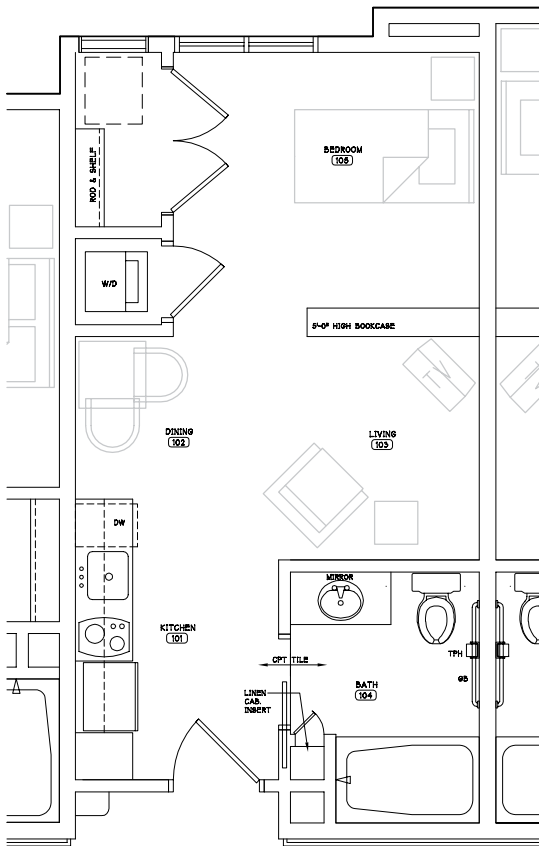

370 Square Feet (approximate)

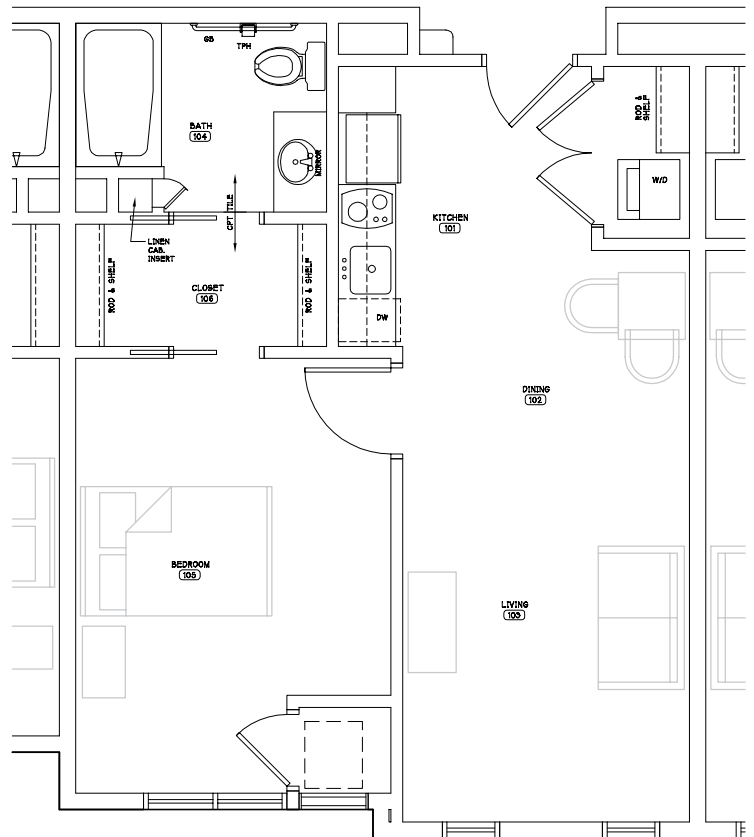

515 Square Feet (approximate)

# Chippewa Falls, Wisconsin Assisted Living Apartments



## Comforts OF Home® *Assisted Living*

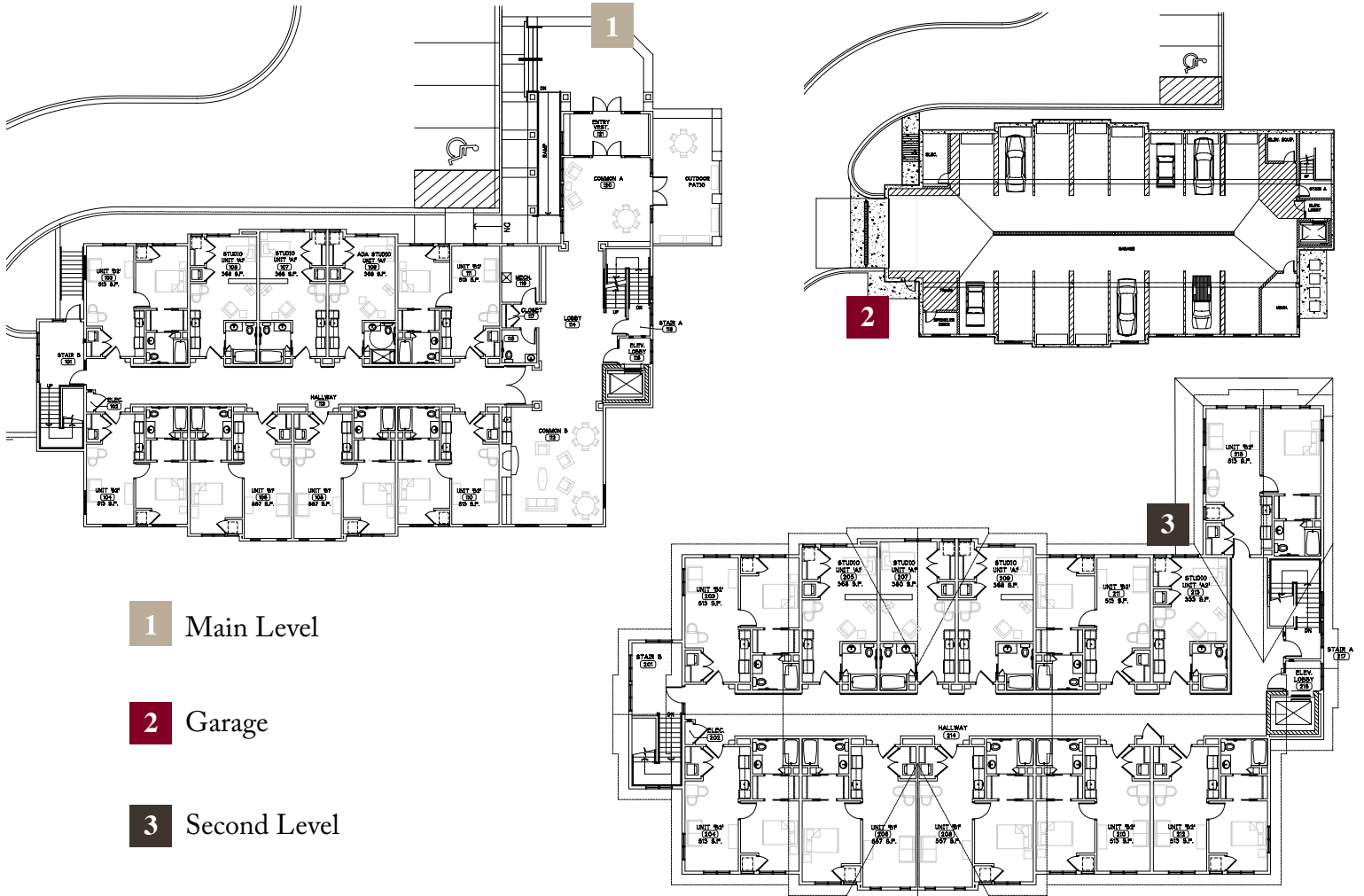

Comforts of Home • 1224 Pumhouse Road, Chippewa Falls, WI 54729 • 715.529.4725 or 800.920.4725

[WWW.COHSENIORLIVING.COM](http://WWW.COHSENIORLIVING.COM)

©2012 Comforts of Home Holdings, LLC